

Installing Microsoft Windows App from Microsoft Store and Opening SSIS

Note: Talk to your IT Department before downloading software.

1. Click the link to find the Windows from the Windows Store.
[Windows App - Free download and install on Windows | Microsoft Store](https://apps.microsoft.com/detail/9n185v95bn7h?en-US&gl=US)
2. Click **Download** or **Get**.
 - i. When installing a Windows app from the app store, you may see the option to **Get** or **Download** depending on your settings.
 - ii. The steps for installation may vary by agency. Consult with your IT department if you need to download this individually or if your IT department has a different process to install this application.
 - iii. After download is complete– continue to Step 3 to access the Windows App.

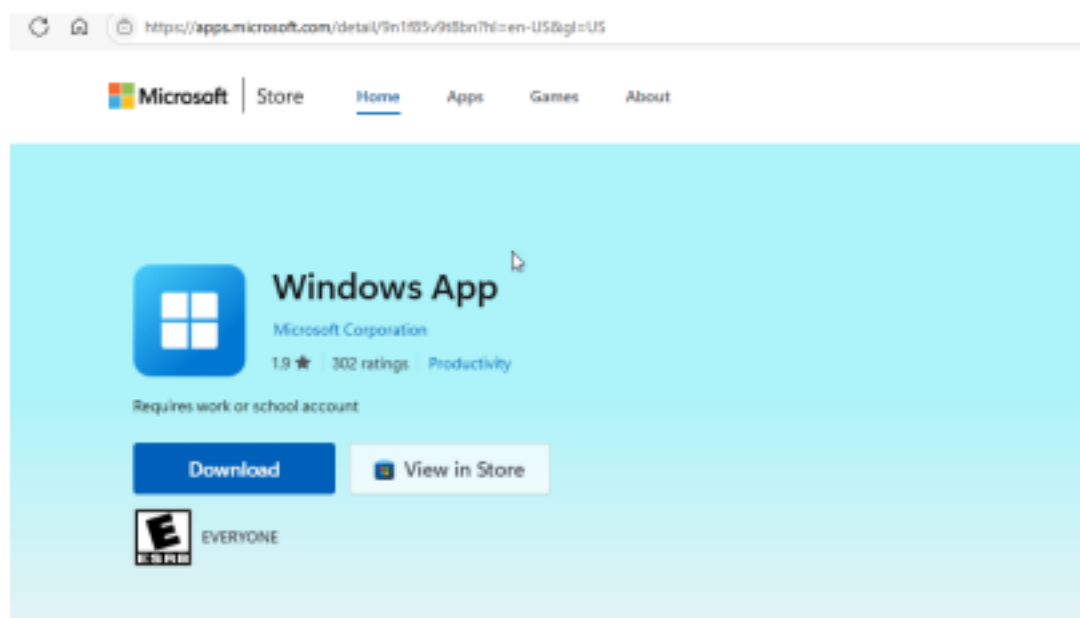

3. Click the **Start** menu on your workstation and type **Windows App** into the Windows search field. Click the **Windows App** result.

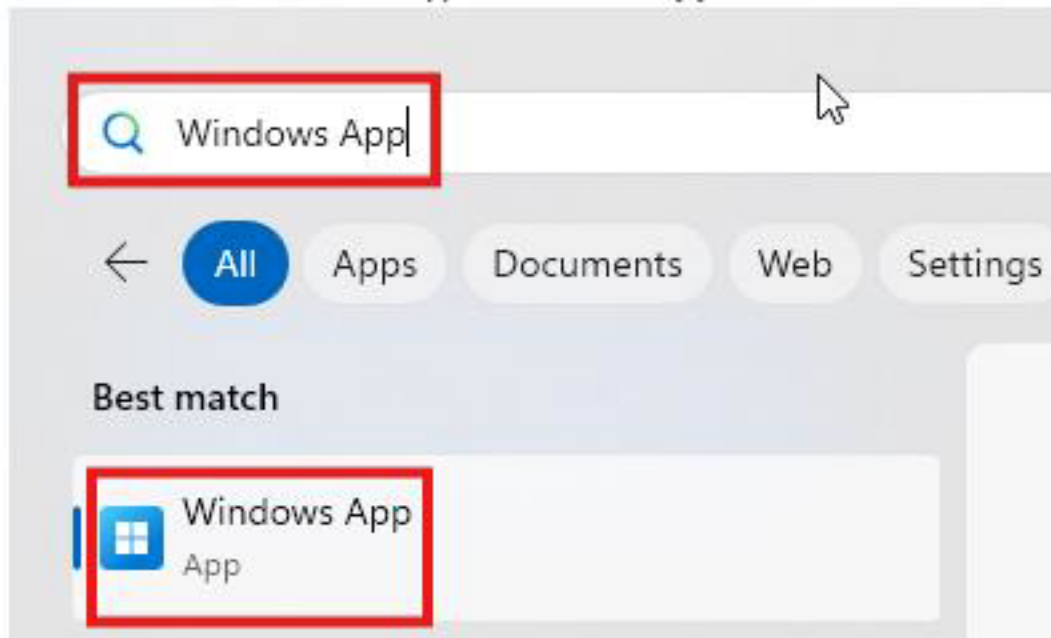

4. After the Windows App launches, if prompted, click the **Skip** button.

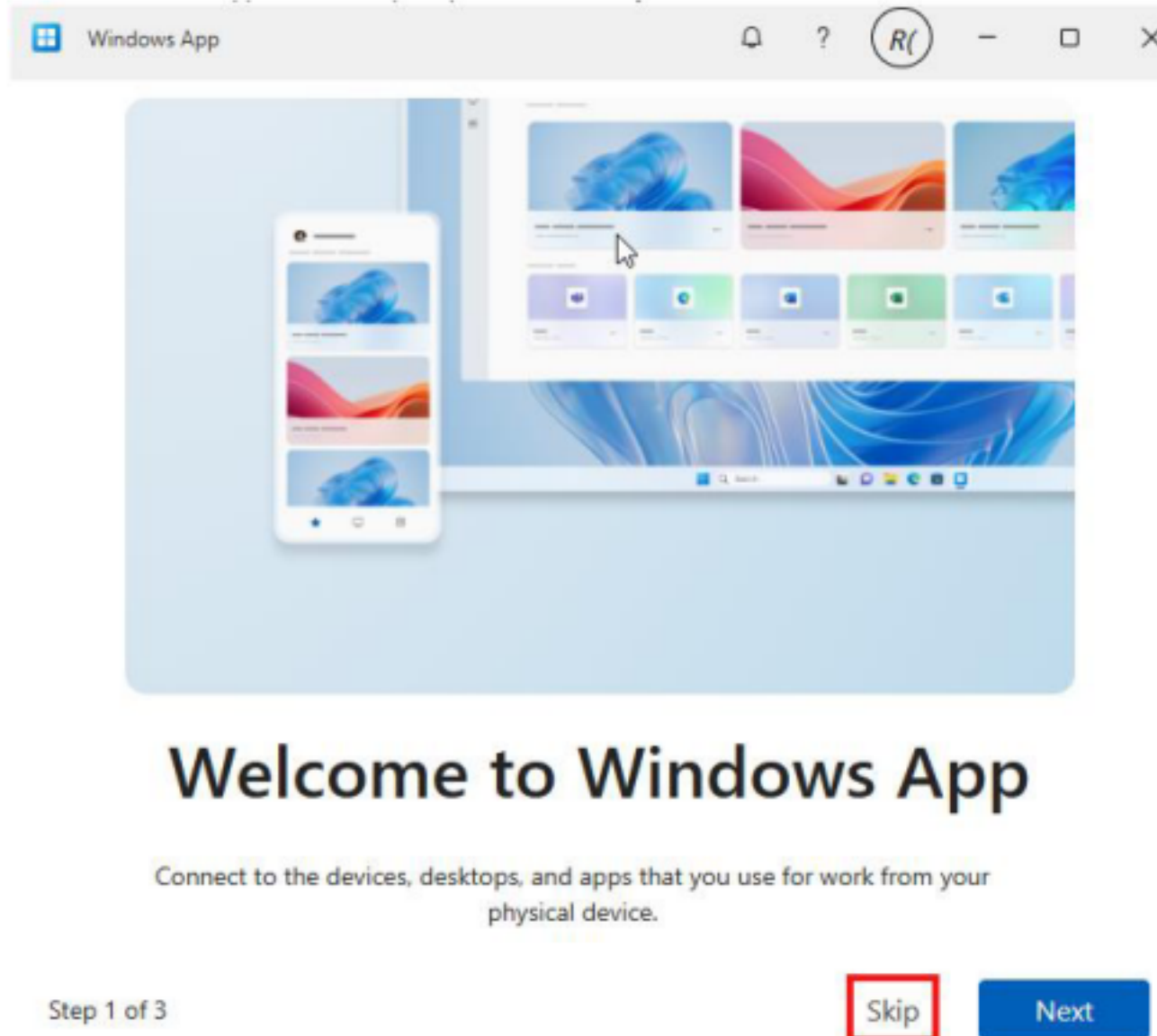

5. Click the **Sign in** button.

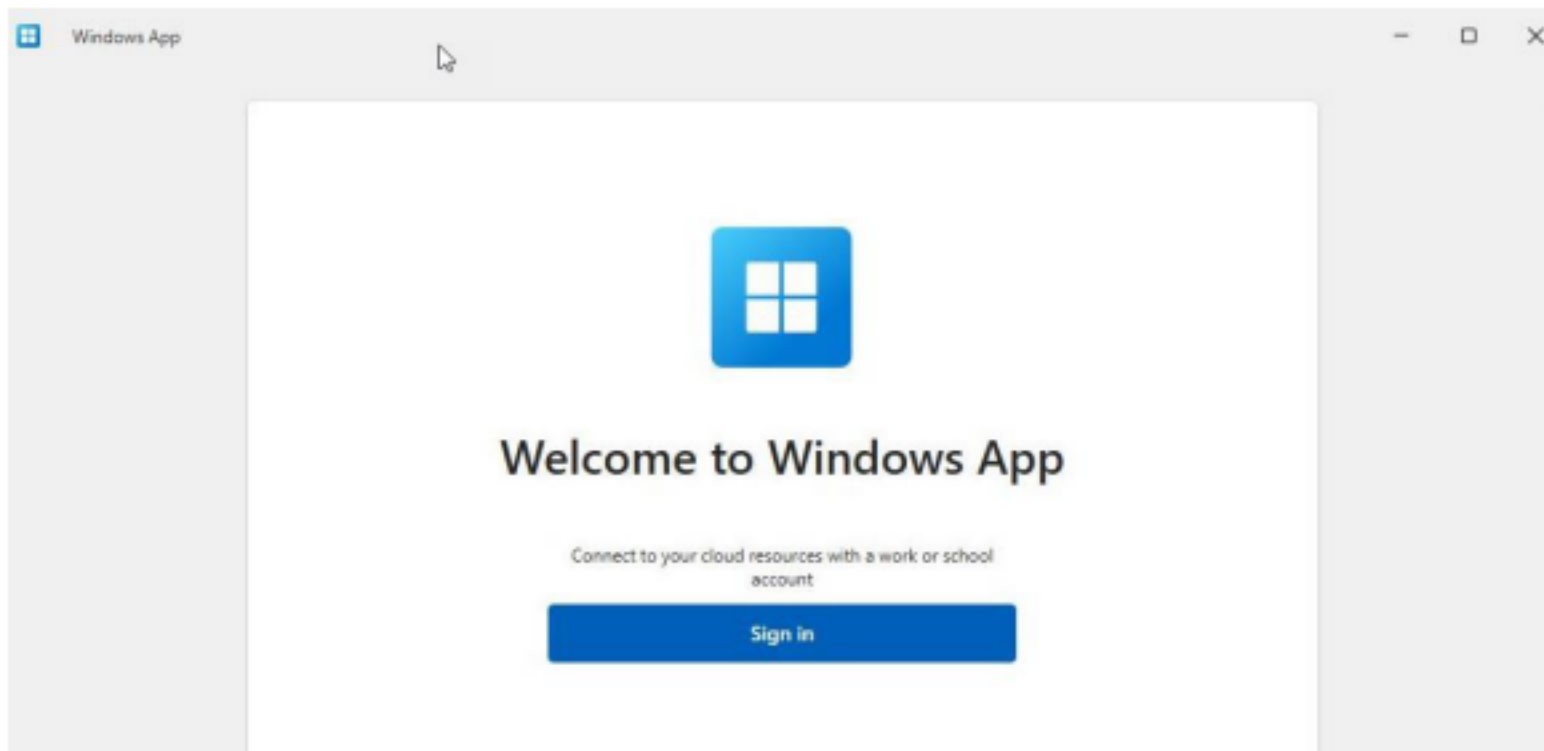

6. On the Pick an account to continue window click **Use another account** option.

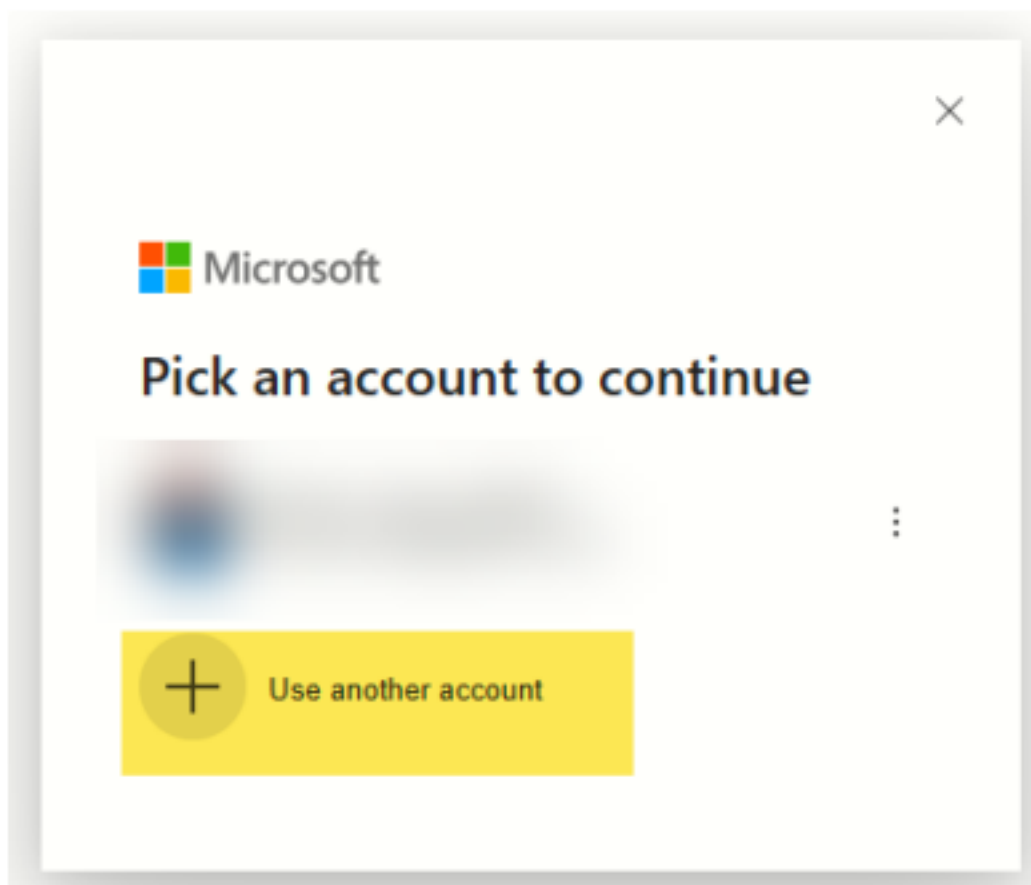

7. Sign in using "**Your SSIS Username**"@partner.mn.gov.

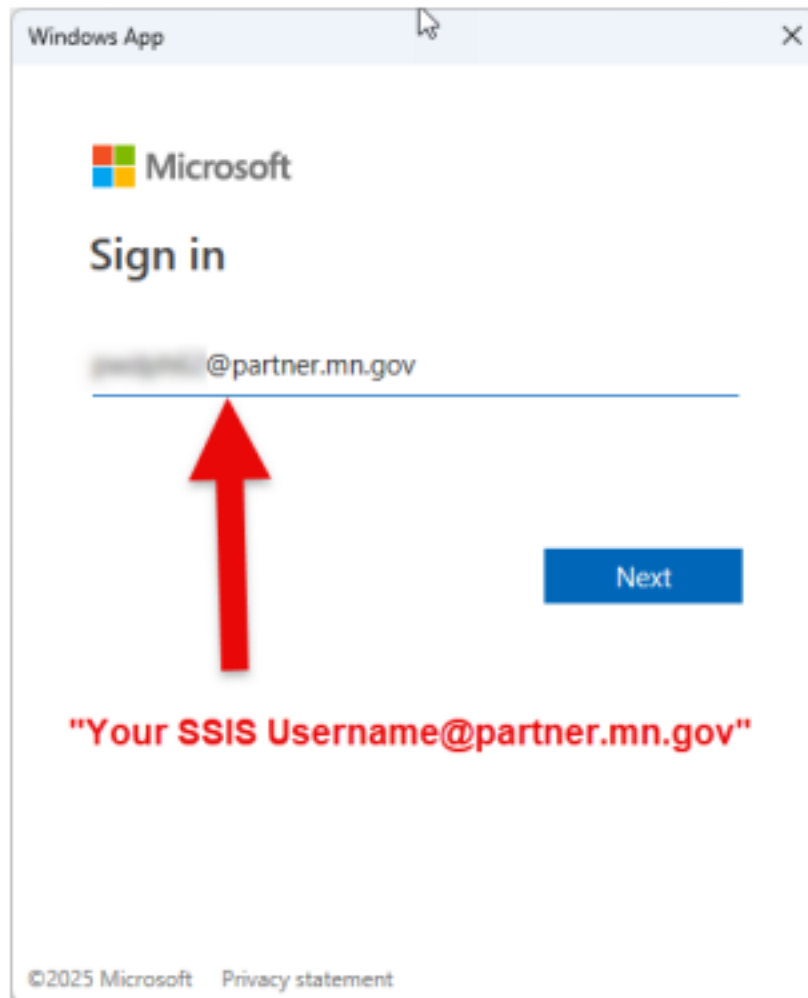

8. Enter your **current SSIS password** on the Enter Password screen.

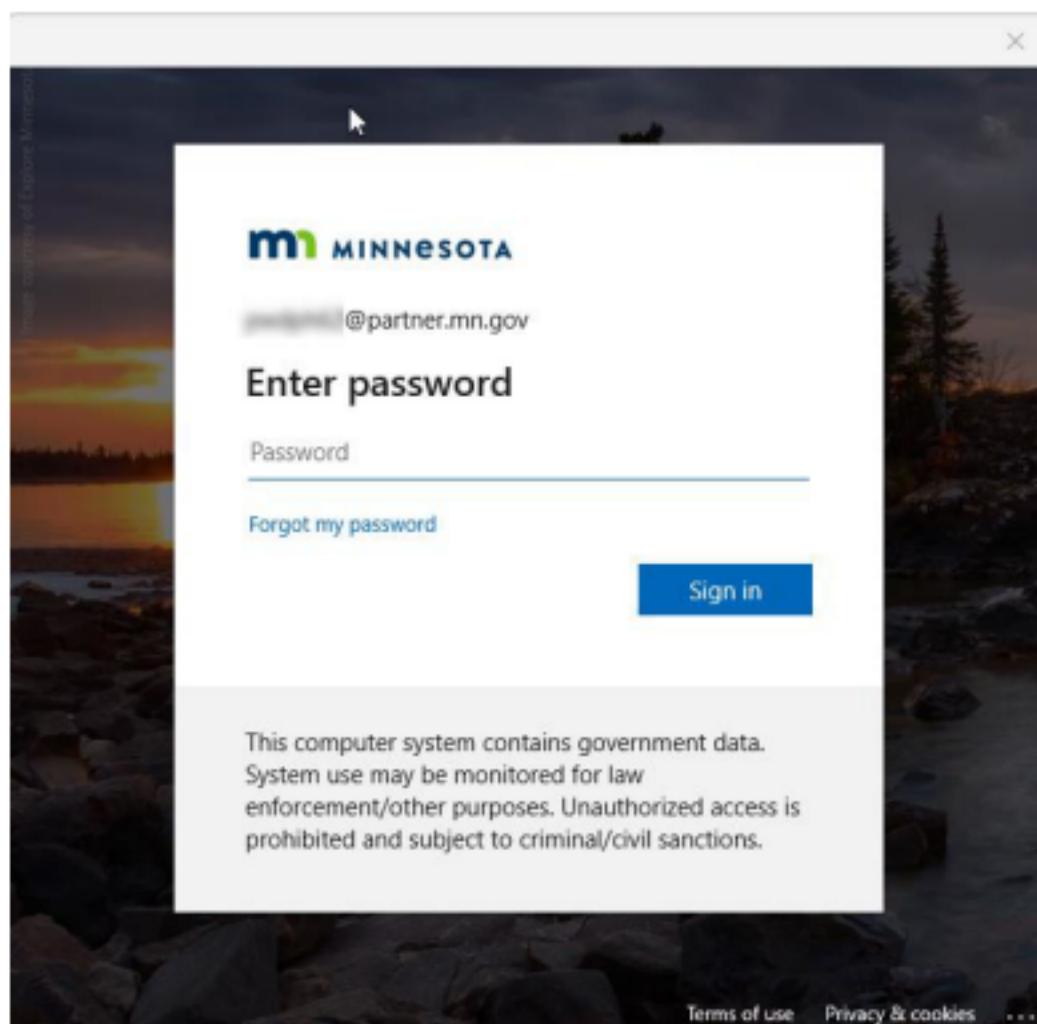

9. On the next screen, click the **Apps icon** to see which SSIS apps are available to you.

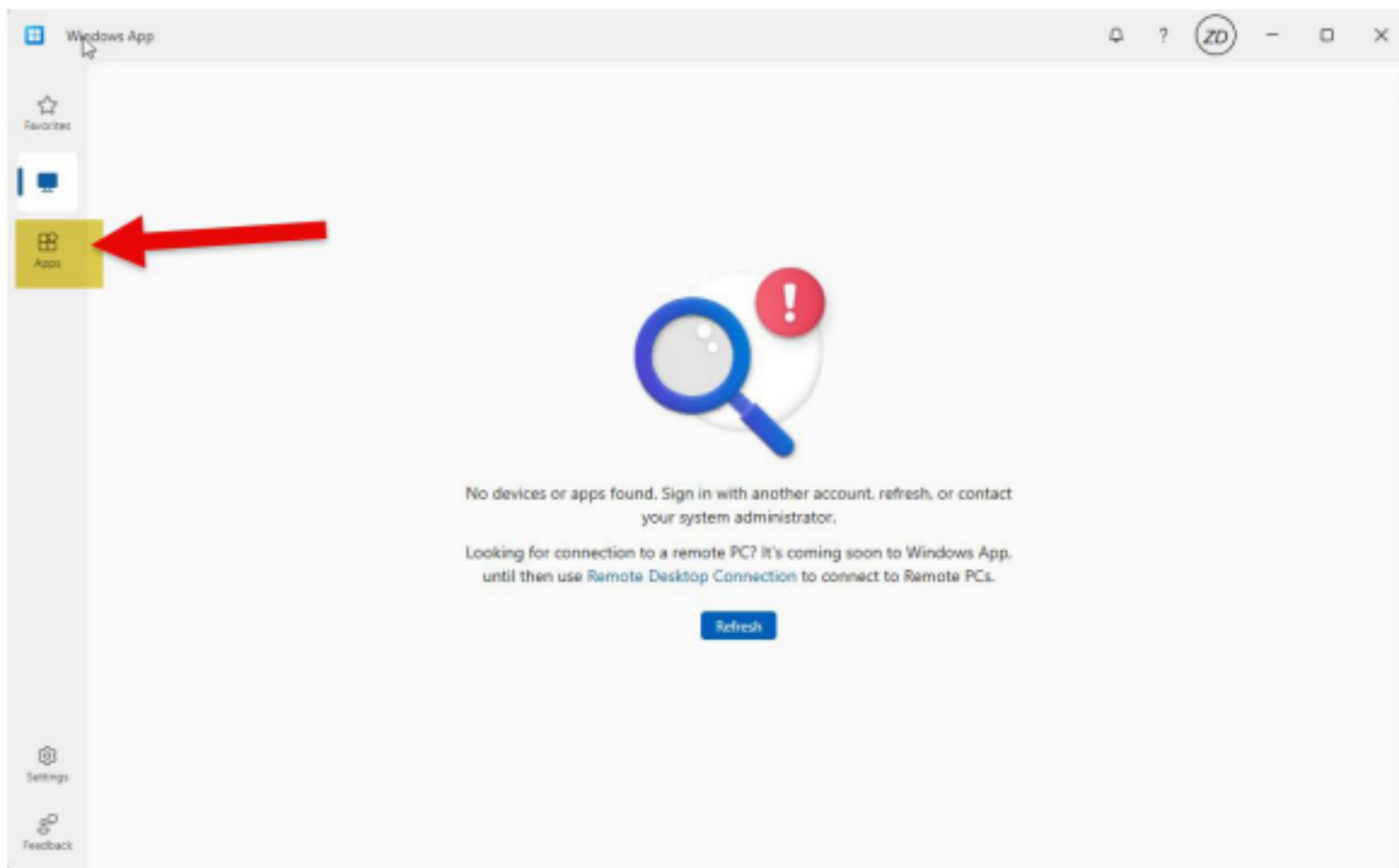

10. This should bring you to all the SSIS apps you have available. To open SSIS, **click the SSIS icon you want to open.**

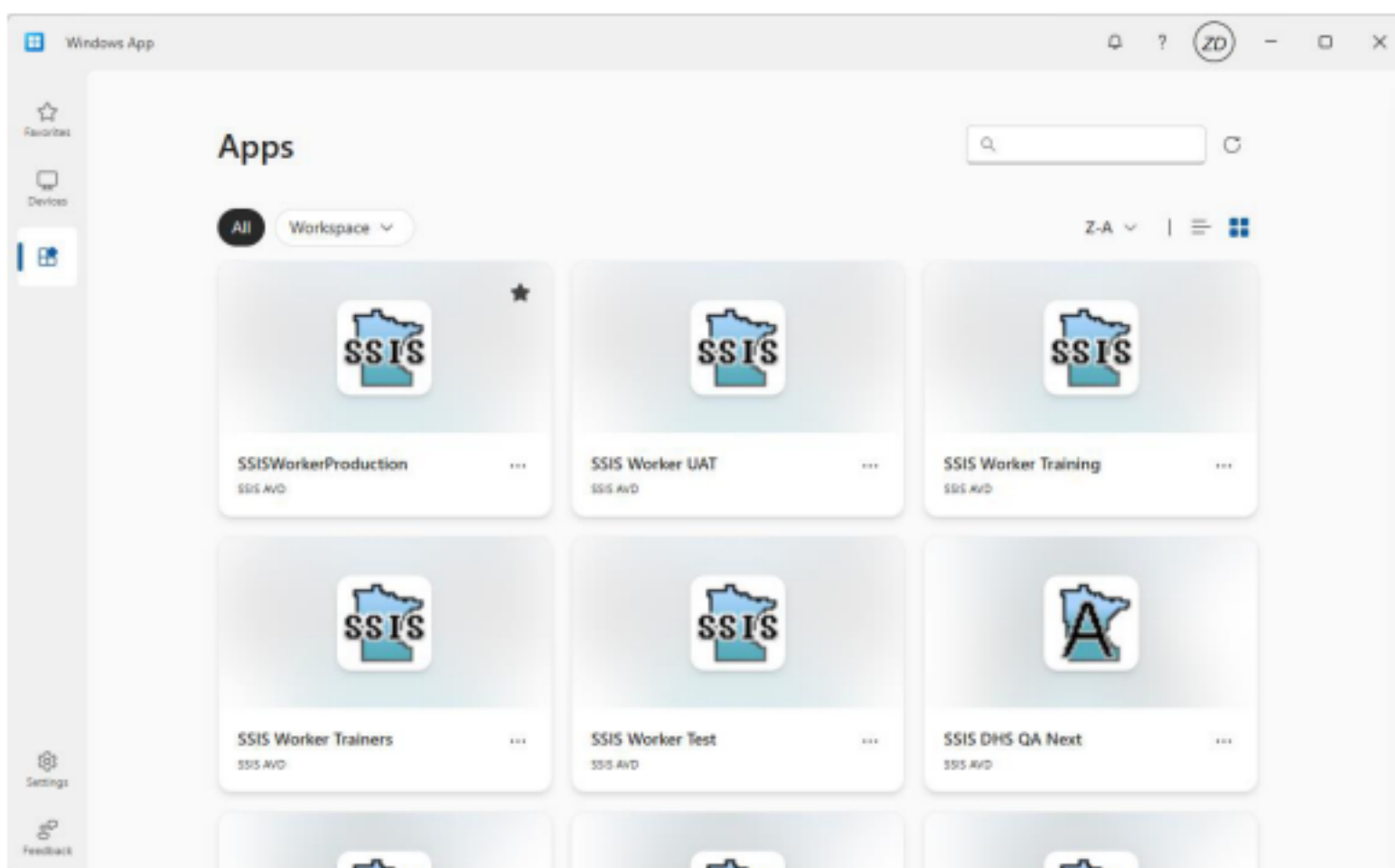

11. Enter your SSIS password when prompted on the next screen.

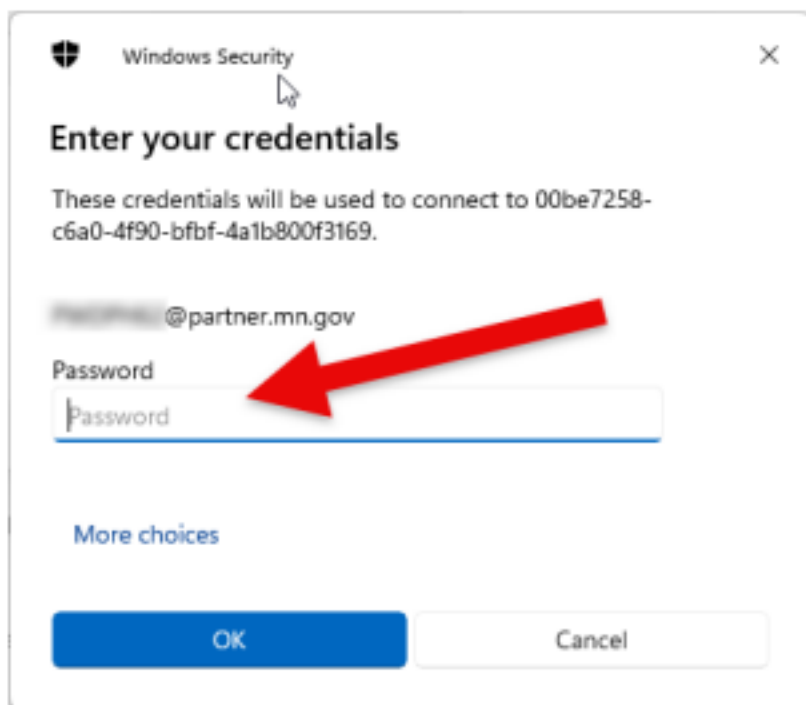

12. Enter your credentials and database into the SSIS login screen.



***If you have any questions, please contact the SSIS Help Desk at dcyf.ssishelp@state.mn.us